

# Sinutec – Cassette

## Wall systems

# Sinutec wall system

Sinutec wall consists of sinusoidal, colour-coated steel panels, fixed horizontally to the secondary framing with self-drilling screws, produced by cold roll forming.

## TECHNICAL SPECIFICATIONS:

- Nominal thickness: variable
- Cover width: 988mm (13 modules of 76mm)  
1000mm (8 modules of 125mm)
- Installation: Horizontal
  - > Steel core: protected by a zinc coat (275 g/m<sup>2</sup>).
  - > Exterior coating: superpolyester on top of a primer coat.

## ASTROTHERM INSULATION:

Sinutec walls facilitate Astrotherm insulation placed between the panel and the secondary framing.

The insulation values are:

Insulation (mm)	40	60	80	80+	100+
U-value W/(m <sup>2</sup> *K)	0,91	0,79	0,61	0,54	0,45









+= with Isobloc

## INSIDE SHEETING:

Plain or perforated (acoustical) inside sheetings are available giving the wall a better appearance by encapsulating the secondary framing.

## COLOURS AND COATINGS:

Coating: Superpolyester 25 micron

Colours:  21  29  31  70  
RAL:  7035  9001  9005  9010

## ACCESSORIES:

- Single or double personnel doors
- Truck doors
- Window frames
- Framed openings
- Wall louvers
- Flashings and trims

NB: For the exact colour, refer to the official Astron colour fan

## ADVANTAGES:

- Aesthetically pleasing, horizontally installed panel
- Discreet external fixings
- High performance and ecological fibre glass insulation
- Inside sheeting to encapsulate secondary framing
- Perforated inside sheeting for noise absorption
- All flashings and connecting parts

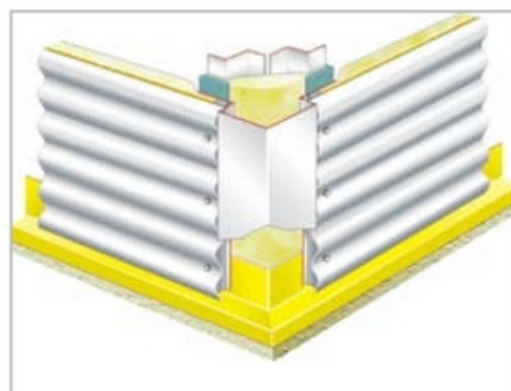
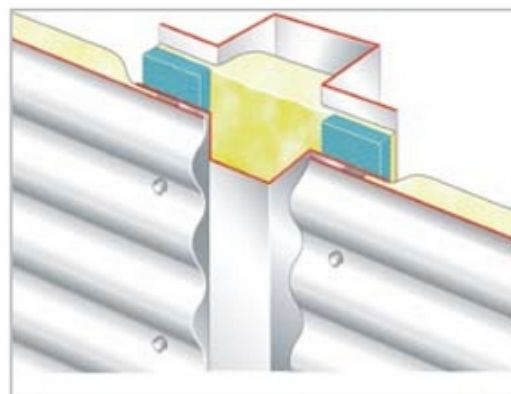



# Cassette wall system

The horizontal liner Cassette wall consists of cold-formed, colour-coated, ribbed steel panels fixed directly with special fasteners to the exterior flange of the building portal frames. The outside cladding can be erected vertically or horizontally.

## TECHNICAL SPECIFICATIONS:

- Nominal thickness: variable
- Cover width: 600mm
- Depth of ribs: 120mm

## SECONDARY FRAMING:

The Cassette liner wall system spans the full bay spacing without the need for any secondary framing. For small and medium-sized framed openings, the structure of the framed openings is concealed within the depth of the wall.

## THERMAL INSULATION:

High density glass-fibre blankets have been specially developed for the cassette walls. The insulation also covers the panel overlaps. An additional Isobloc is installed at the overlaps for improved thermal performance.

## COLOURS AND COATINGS:

Interior side: grey white superpolyester

## ACCESSORIES:

A range of fully compatible accessories is available. They ensure complete watertightness and pleasing aesthetics:

Single or double personnel doors

- Truck doors
- Window frames
- Frames openings
- Wall louvers
- Flashings and trims

## ADVANTAGES:

- Attractive interior finish
- Simple and economical parapets, mainly in combination with low pitch roofs
- Framed openings concealed within the Cassette wall
- Allows horizontal or vertical cladding
- High performance thermal and acoustical insulation
- Quick erection

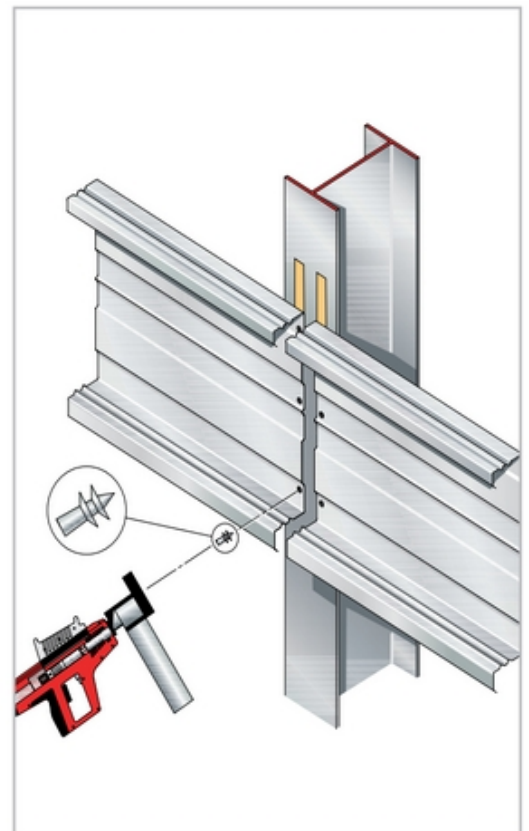
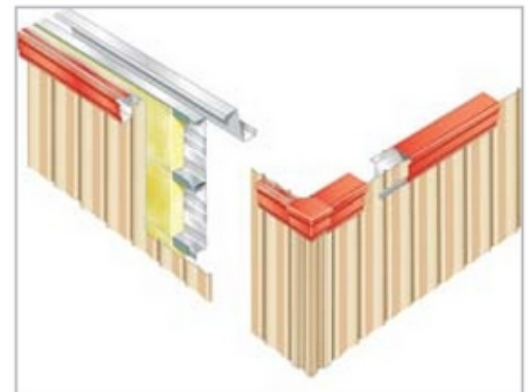
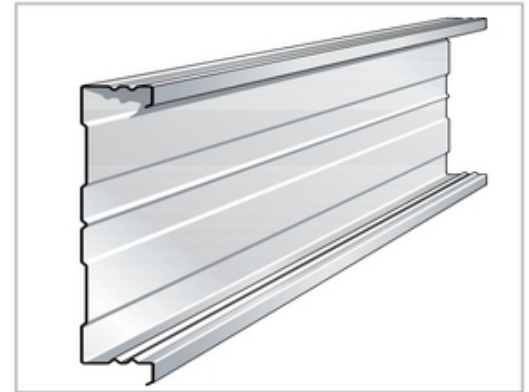

# www.astron.biz



Astron is the brand name of the products sold by the Building Systems Business area of the Lindab group, Europe's largest manufacturer of steel building systems for industrial, office and commercial use.

Lindab-Astron produce up to 1,000 buildings a year, distributed either through a network of 400 certified independent Builders, spanning nearly 40 countries or through our Key Accounts Unit. Our headquarters is located in Diekirch (Luxembourg). Lindab's concept is clear and simple:

## We simplify construction

### Lindab-Astron:

<http://www.astron.biz/contact/Astron.html>

#### Luxembourg:

Route d'Ettelbruck  
L-9230 Diekirch  
Tel.: +352 80291-1  
Fax: +352 803466

#### Czech Republic:

Kojetinská 71  
CZ-75053 Píerov  
Tel.: +420 581 250 222  
Fax: +420 581 250 205

#### Hungary:

Derkovits u. 119.  
H-4400 Nyíregyháza  
Tel.: +36 42 501 310  
Fax: +36 42 312 029

#### Russia:

ul. Sovetskaya 69  
RUS-15003 Yaroslavl  
Tel.: +7 4852 42 70 43  
Fax: +7 4852 42 70 43-115

#### Germany:

Wilh.-Theodor-Römhheld-Str. 32  
D-55130 Mainz  
Tel.: +49 (0)6131 8309-00  
Fax: +49 (0)6131 8309-20

#### Poland:

ul. Kolejowa 311  
Sadowa  
PL-05-092 Łomianki  
Tel.: +48 (0)22 489 88 91  
Fax: +48 (0)22 489 88 98

#### France:

20, r. Pierre Mendès-France  
Torcy, CEDEX 01  
F-77202 Marne-la-Vallée  
Tel.: +33 (0)1 6462-1616  
Fax: +33 (0)1 6462-1092

#### United Kingdom:

Evans Business Centre  
Mitchelston Ind. Estate  
GB-Kirkcaldy, Fife  
Scotland KY13 UF  
Tel.: +44 1592 65 23 00  
Fax: +44 1592 65 31 35

#### Russia:

14G, Magistralnaya str.  
Building 1  
RUS-123290 Moscow  
Tel.: +7 495 981 3960  
Fax: +7 495 981 3961

#### Ukraine:

Saksaganskogo Str. 123  
office 3  
UA-01032 Kiev  
Tel.: +380 44 490 6164  
Fax: +380 44 490 6759

#### Romania:

Soseaua de Centura nr. 8  
Stefanestii de Jos  
RO-077175 Ilfov  
Tel.: +40 21209 4100  
Fax: +40 21209 4124

#### Italy:

Via S. Martino Solferino 40  
I-35122 Padova  
Tel.: +39 333 3286388  
Fax: +39 049 658367

#### Bulgaria:

Str. Captain D. Spisarevski N°38  
BG-1592 Sofia, Drujba 1  
Tel.: +359 2 979 97 00  
Fax: +359 2 979 97 01

#### Belarus:

pr-t gazety "Prawda", 11  
BY-220116 Minsk  
Tel.: +375 29 311 44 59  
Fax: +375 17 270 38 95

#### Lithuania:

Mokslininkų g. 20  
LT-08412 Vilnius  
Tel.: +370 5 272 97 29  
Fax: +370 5 272 97 30